

E-Z GLIDE DIRECTIONAL VALVE BYPASS KIT FOR OPEN-CENTER HYDRAULIC SYSTEMS ASSEMBLY INSTRUCTIONS

The E-Z Glide hydraulic wheel kit for the 10" and 12" swing away hoppers uses a closed-center hydraulic directional control valve. This kit allows the directional valve to be bypassed when not in use to accommodate tractors with open-center hydraulic systems. When the directional valve control lever is placed in the neutral (center) position and the bypass shutoff valve is opened, the bypass allows oil to circulate back to the tractor hydraulic tank and prevents the tractor open-center hydraulic system from developing pressure. With the shutoff valve closed, the directional valve will also function normally as a closed-center valve allowing it to be used with tractors with closed-center or open-center hydraulic systems.



Read the safety guidelines in the 10" & 12" Swing Away Hydraulic Hopper Wheel Kit Assembly Manual, PNEG-1334, before proceeding with the assembly of the bypass kit.

ASSEMBLY (REFER TO FIGURE 1):

1. Lower the hopper to the ground, remove the lift cable and swing the hopper out away from the main auger tube so that both sides of the directional valve are accessible. Disconnect the pressure and return hoses from the tractor.
2. Disassemble the pressure and return hoses from the directional valve. Have a small bucket available to catch any oil leakage from the hoses and valve and/or have ½" NPT pipe caps available to cap the hose fittings.



Loosen the hose fittings slowly. There may be some residual pressure remaining in the hoses that will relieve as the fittings are loosened.

3. Check the location of the ½" NPT orifice adapter. If it is not already assembled to one of the ½" NPT 90° elbows in the directional valve ports to the hydraulic motor, it must be relocated to one of these elbows.
4. Remove the 90° elbow from the inlet port of the directional valve and assemble the ¾" NPT X ½" NPT straight adapter [1] into the inlet port.
5. Assemble the ½" NPT tee [2] to the ¾" NPT X ½" NPT straight adapter [1] as illustrated in Figure 1.
6. Assemble the ½" NPT female run tee [3] to the ¾" X ½" NPT straight adapter already installed in the directional valve outlet port.
7. Assemble the shutoff valve [4] to the ½" NPT female run tee [3] as illustrated in Figure 1.
8. Assemble the hose [5] to the tee [2] and shutoff valve [4] as illustrated in Figure 1.
9. Reassemble the pressure and return hoses to the ½" NPT tee [2] at the directional valve inlet port and the ½" NPT female run tee [3] at the directional valve outlet port. Reconnect the hoses to the tractor.

The GSI Group
1004 East Illinois Street
Assumption, IL 62510
217-226-4421 Phone
800-800-5329 Fax

Copyright © 2005 by The GSI Group
Printed in the USA

PNEG-1489
12-01-05



PNEG-1489

OPERATION:

1. With a tractor with a closed-center hydraulic system, close the shutoff valve in the bypass circuit (valve handle perpendicular to the valve body) and leave closed at all times.
2. With a tractor with an open-center hydraulic system:
 - A. Close the shutoff valve in the bypass circuit (valve handle perpendicular to the valve body) when operating the directional valve control lever to operate the hydraulic motor in the forward and reverse directions to move the hopper.
 - B. Open the shutoff valve in the bypass circuit (valve handle in line with the valve body) when the directional valve control lever is placed in the neutral (center) position. This allows oil to bypass the closed-center valve when its ports are blocked in the neutral position and prevents the tractor hydraulic system from continuing to pump pressure.

Bypass Kit Parts List		
Item #	Part #	Description
1	GK7459	Hyd. Adapter: Hex Nipple, 3/4" NPT X 1/2" NPT
2	GK4431	Hyd: Tee Ftg. 1/2" Pipe, 3 Fem.
3	GK7461	Hyd. Adapter: Female Run Tee, 1/2" NPT
4	GK1533	Hydraulic Ball Valve, 1/2"
5	GK7462	Hyd. Hose: 3/8 ID X 24"L, 1/2" NPT

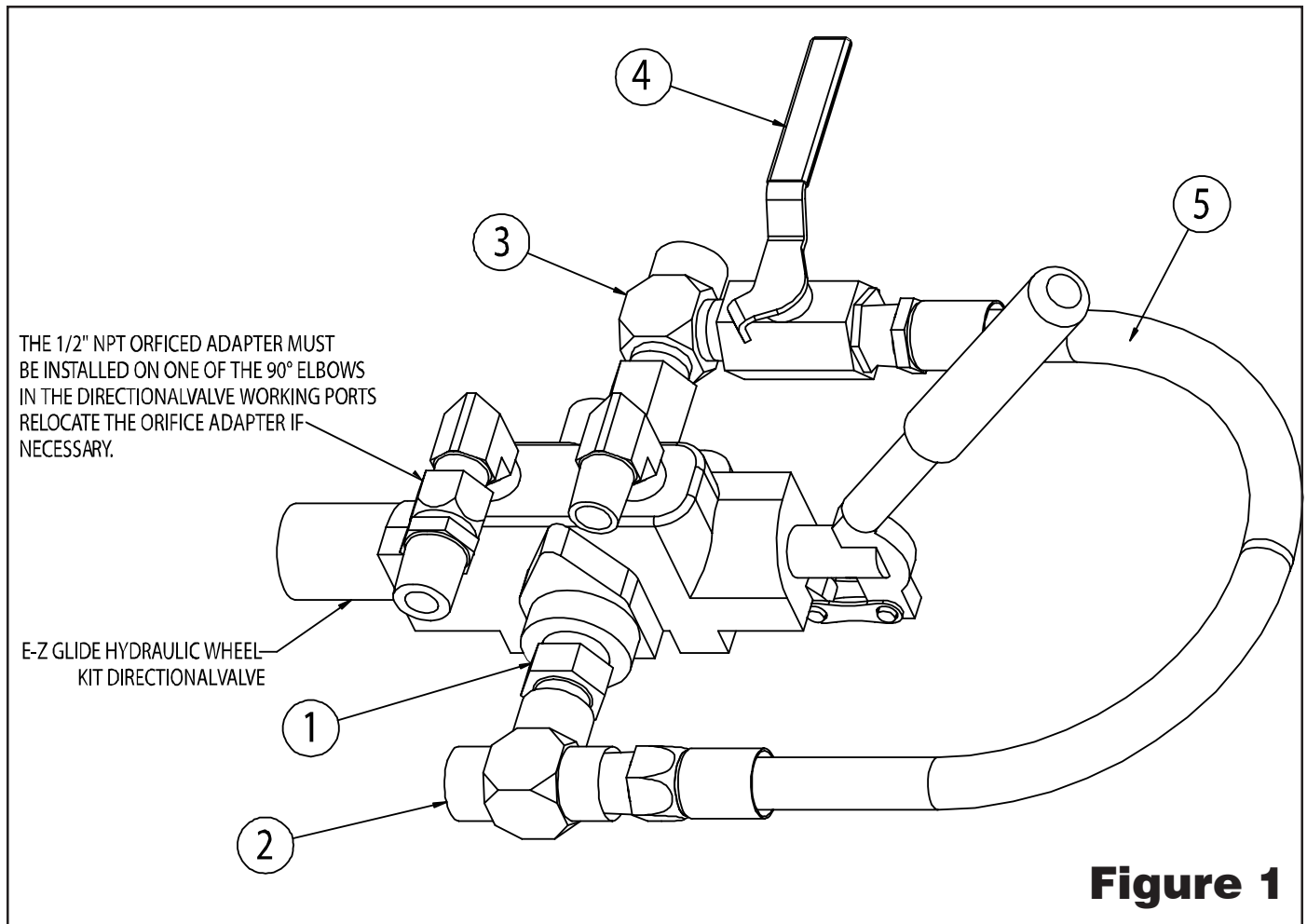

Figure 1