



1. Using one of the metal facing rings (A) as a guide, trace center and bolt hole pattern on hopper sheet at desired location.
2. With, appropriate tools, remove 4-1/4" center hole from hopper panel. Center punch the eight (8) hole locations and drill using 3/8" diameter bit.
3. Center plexiglas window (B) between facing ring (A) and flat gasket (C). Then take components and align and place gasket against exterior surface of hopper panel (F).
Align and place second facing ring (A) on interior surface of hopper panel (F).
4. Secure components together with eight (8) 5/16" bolts (D) and nuts (E) supplied.

NOTE: DO NOT OVER TIGHTEN, AS DAMAGE TO PLEXIGLAS WINDOW (B) MAY OCCUR.

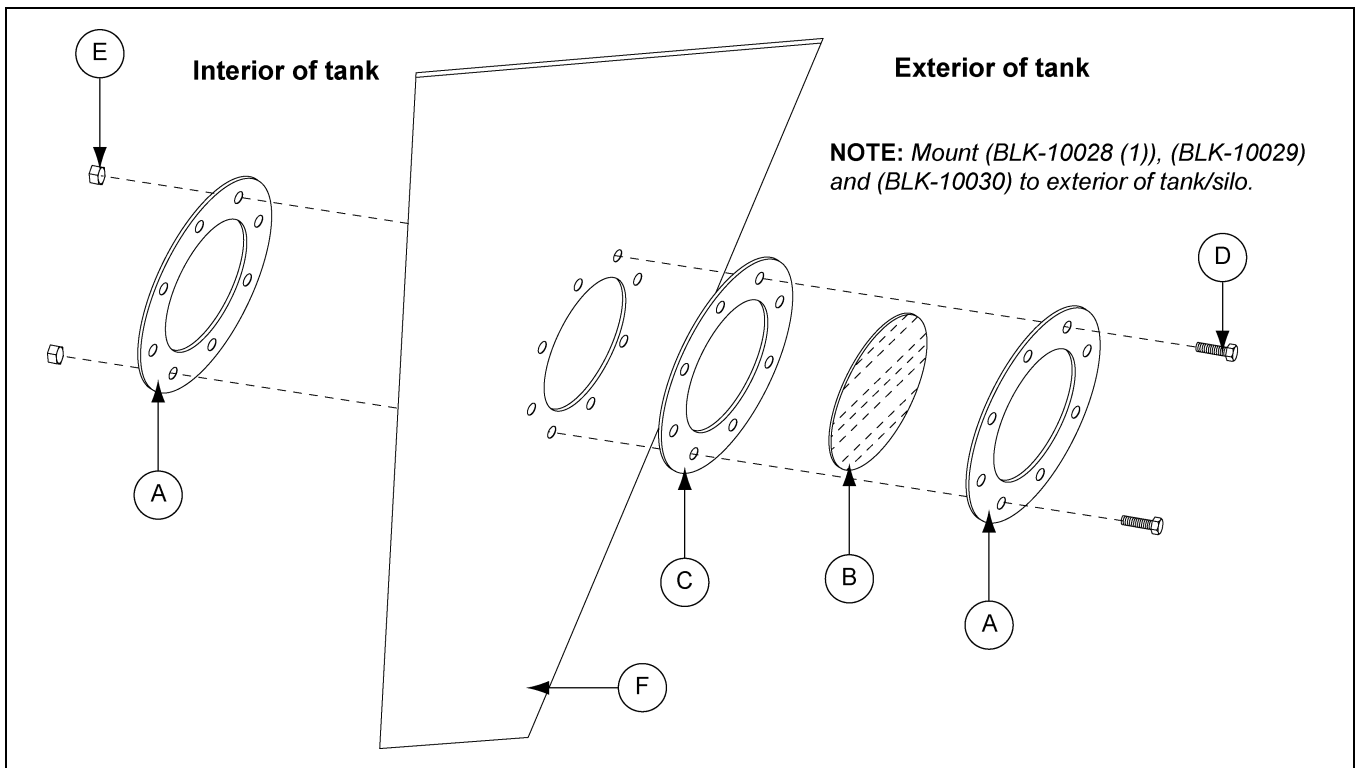

Figure 1

Ref #	Part #	Description
A	BLK-10028	Facing Ring
B	BLK-10030	Plexiglas Window
C	BLK-10029	Flat Gasket
D	S-10260	Flange Bolt 5/16"-18 x 1" JS500 Grade 8 or Grade 8.2
E	S-7484	Hex Nut 5/16"-18 JS500 Grade 5
F		Hopper Panel

