



When using a pneumatic fill kit, it is necessary to install the sealing ring and cap latch components to the bulk feed tank lid and peak collar. Use the following instructions to properly install these components.

Install plugs (BLK-13319) as shown in [Figure 1](#). Use a rubber mallet if necessary. The plugs are required to keep feed from blowing into the lid cavity. Next, assemble the peak collar extension (BLK-13316) as shown in [Figure 2 on Page 2](#). It is to be placed directly on top of the peak collar and then bolted to the existing rubber belting using standard bin hardware. It will be necessary to drill 3/8" diameter holes through the rubber belting. Next push the bulb seal strip over the hemmed edge of the peak collar extension. (See [Figure 5 on Page 3](#).)

Install cap latch components as shown in [Figure 3 on Page 2](#). It may be necessary to remove the ground control arm if lid ground control has been previously assembled on the tank. [Figure 4 on Page 3](#) shows the finished latched cap.

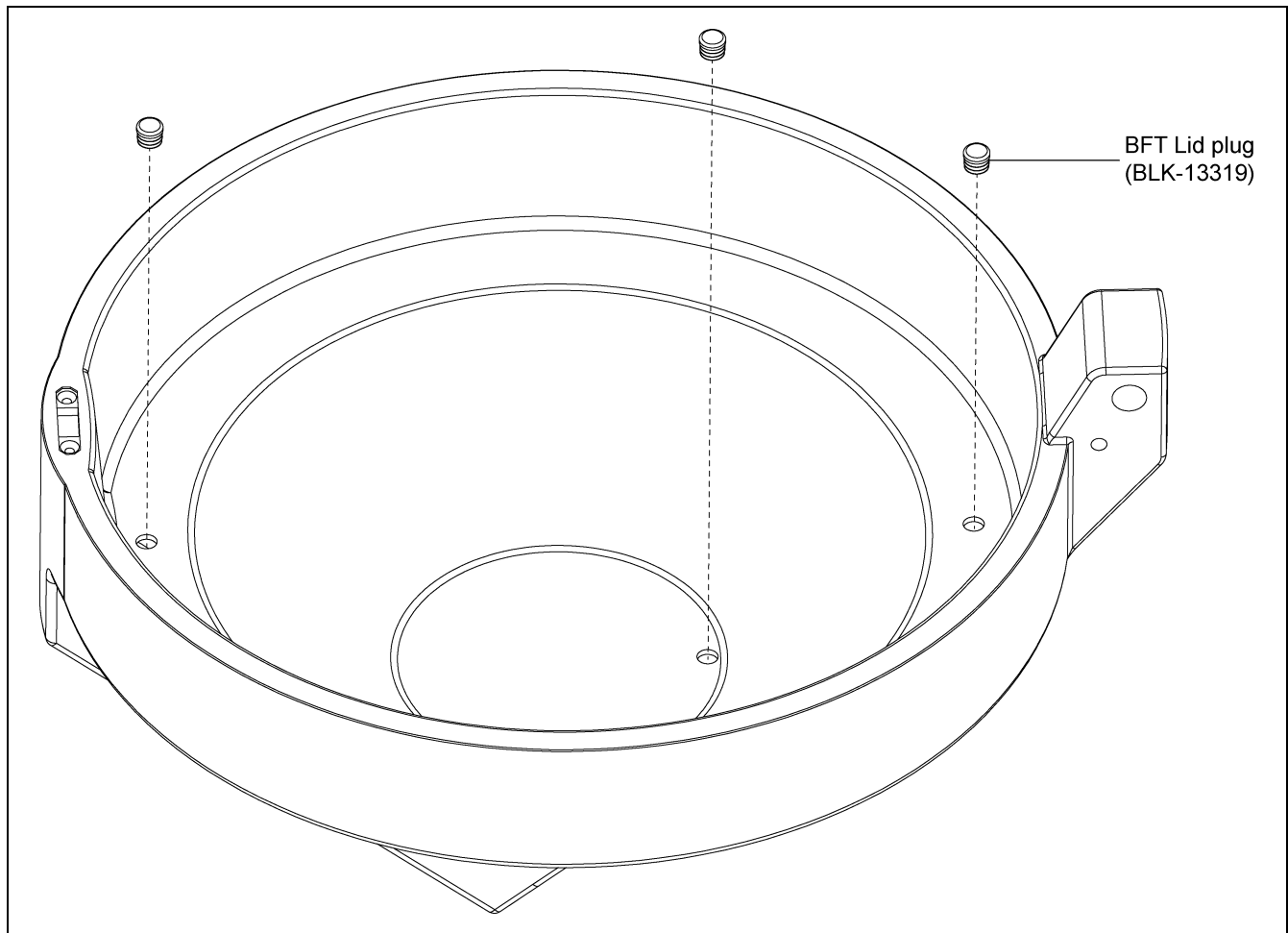

Figure 1



BFT Lid Cap Latch Installation

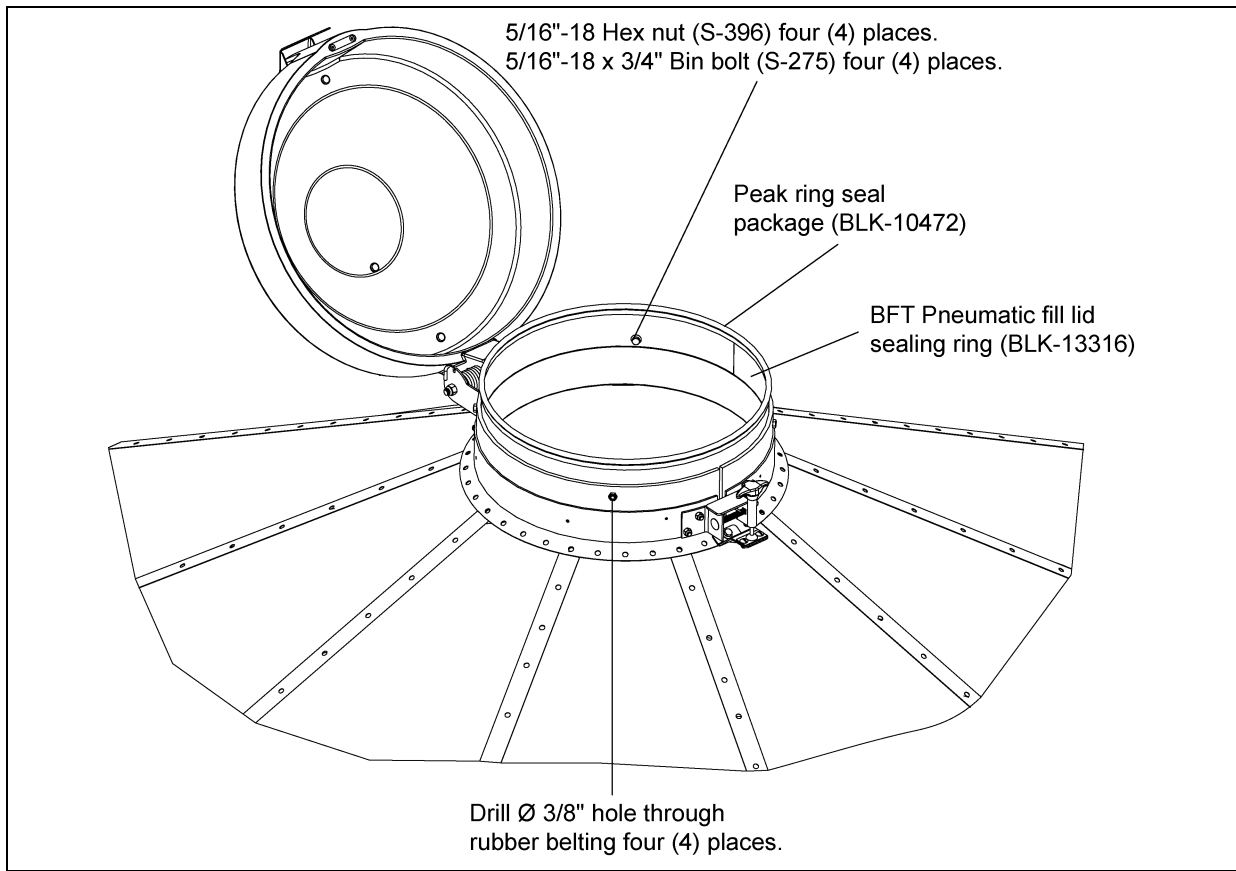

Figure 2

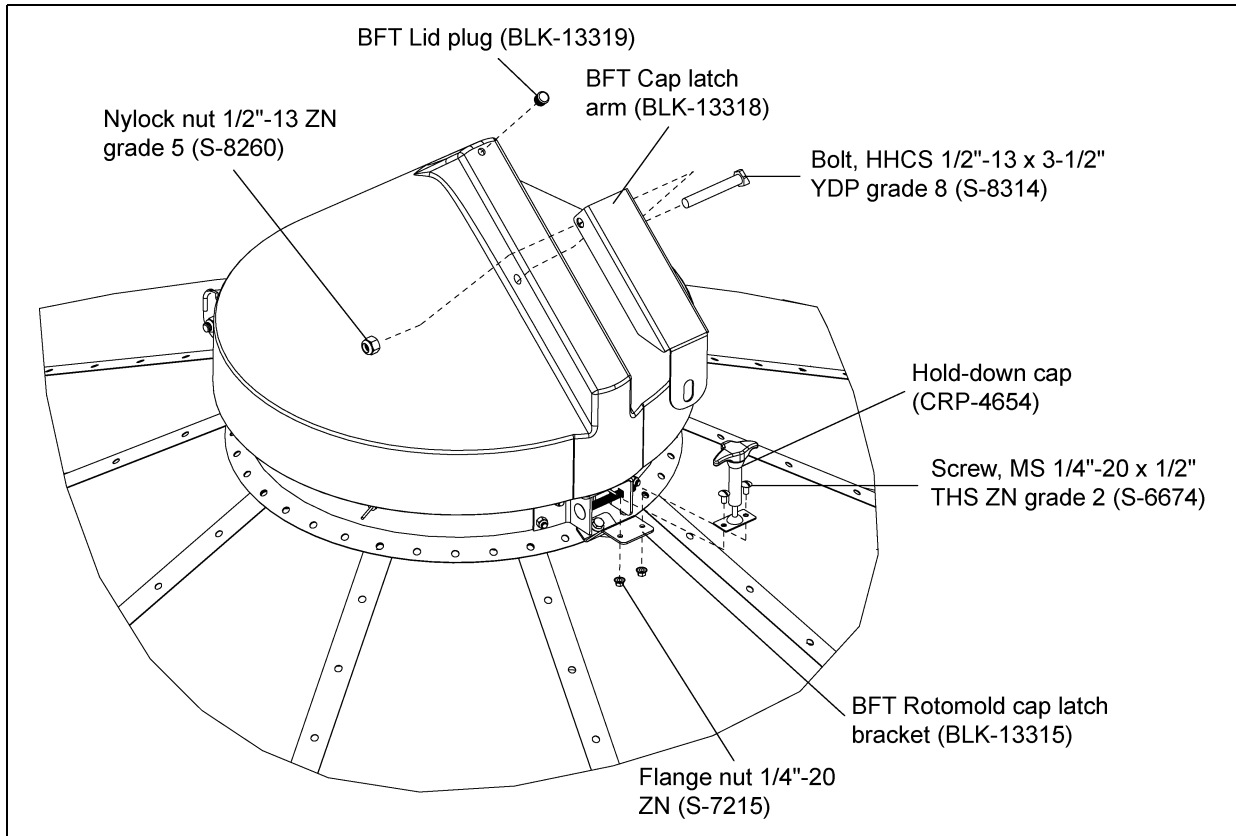

Figure 3

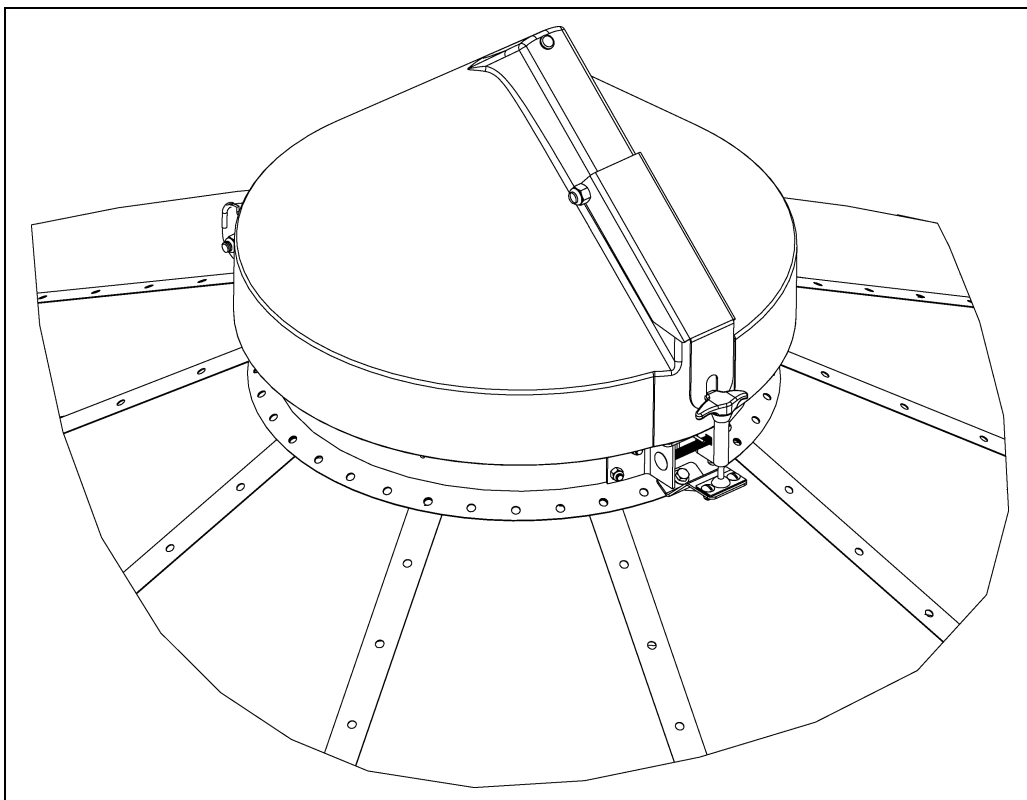

Figure 4



Figure 5